

February 2015

## System:- NV8 System

aluminium support system for  
rain screen cladding panels

## NVELOPE SYSTEM NV8

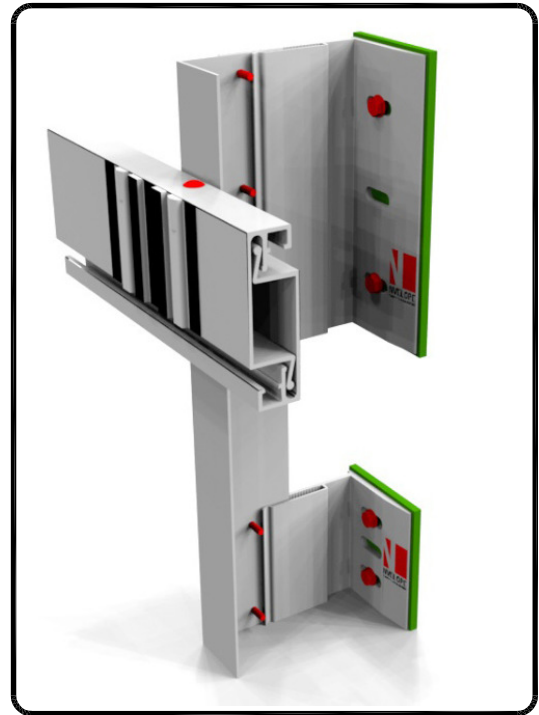

### CONTENTS:

- NV8-01 Tolerances for adjustment
- NV8-02 Horizontal section – NVELOPE 90
- NV8-03 Vertical section – NVELOPE 90 SINGLE
- NV8-04 Vertical section – NVELOPE 90 DOUBLE
- NV8-05 Horizontal section–external corner
- NV8-06 Horizontal section–internal corner
- NV8-07 Final fix detail
- NV8-08 Hanger and rail dims
- NV8-09 Adjusting screw details

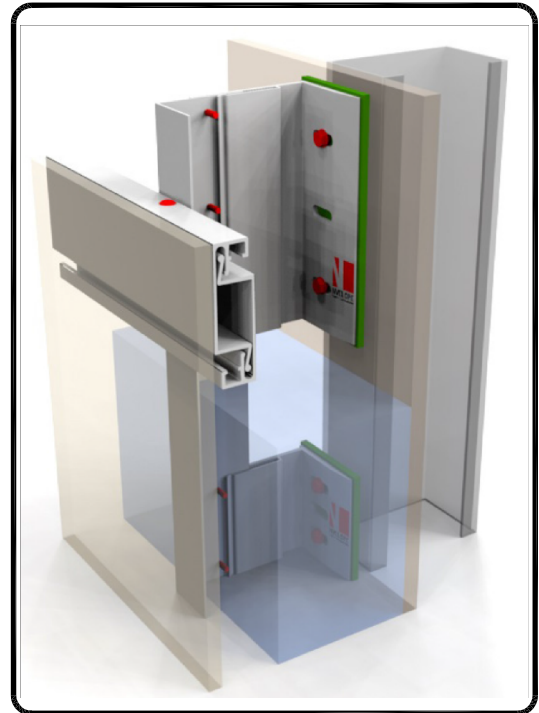

### LEGEND:

- A – Cladding SHEET
- C1 – Secret fixing hanger with levelling screw
- C2 – Secret fixing hanger.
- D – Screw
- E – Fixing screw
- F – Window profile
- 1 – Steel frame wall
- 2 – NVELOPE – support bracket
- 3 – Primary Fixing
- 4 – L profile vertical ( 60 X 40 X 2.2 )
- 5 – SR2 self drilling stainless steel screw
- 6 – Horizontal Profile
- 7 – Insulation
- 8 – Ventilation
- 10 – NVELOPE Isolator

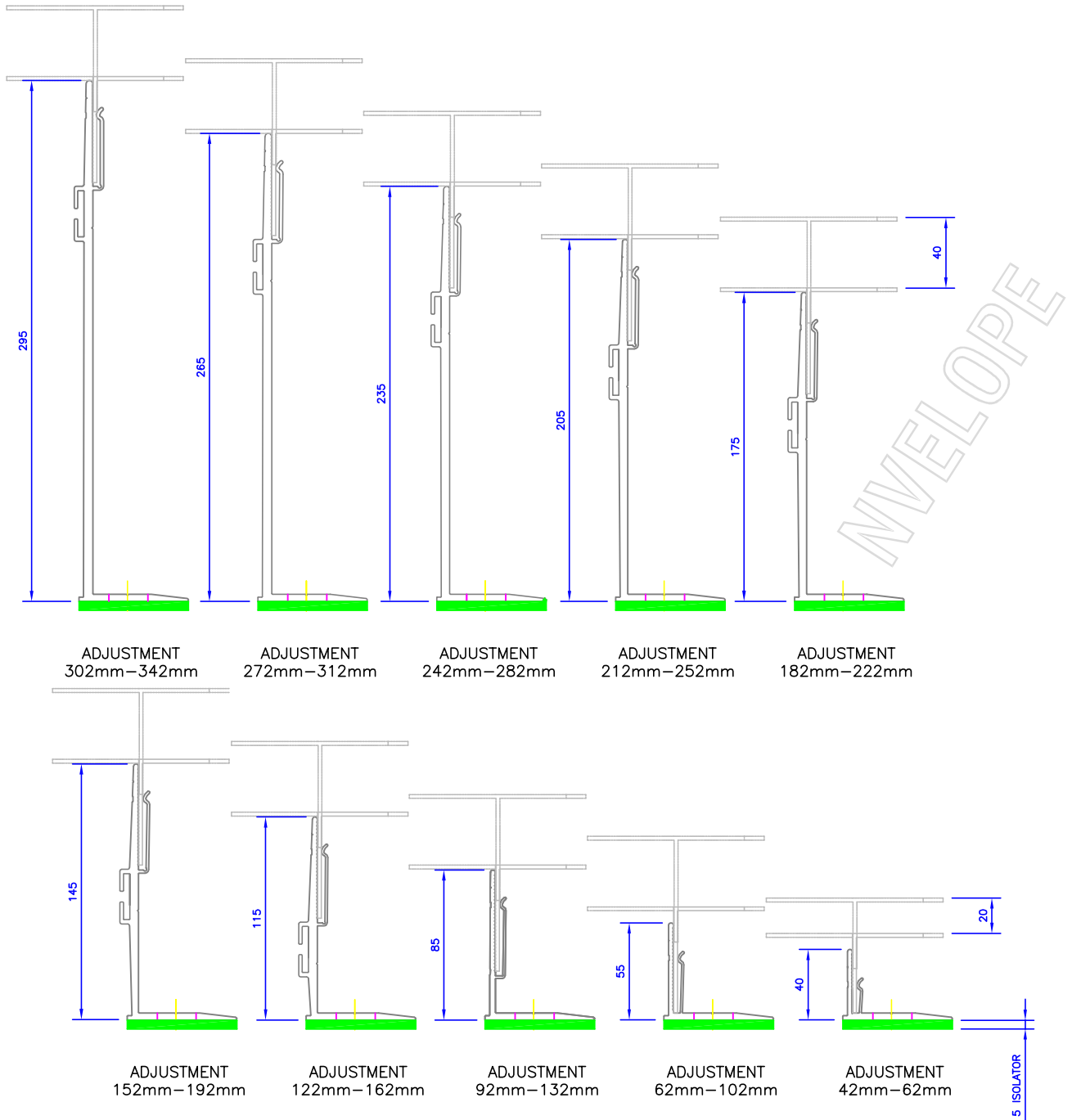

BRACKETS	Adjustment range for each bracket ( mm )	
Nvelope 40	from 42	to 62
Nvelope 60	from 62	to 102
Nvelope 90	from 92	to 132
Nvelope 120	from 122	to 162
Nvelope 150	from 152	to 192
Nvelope 180	from 182	to 222
Nvelope 210	from 212	to 252
Nvelope 240	from 242	to 282
Nvelope 270	from 272	to 312
Nvelope 300	from 302	to 342

HORIZONTAL SECTIONS  
TOLERANCES FOR ADJUSTMENT

February 2015

System:- NV8 SYSTEM

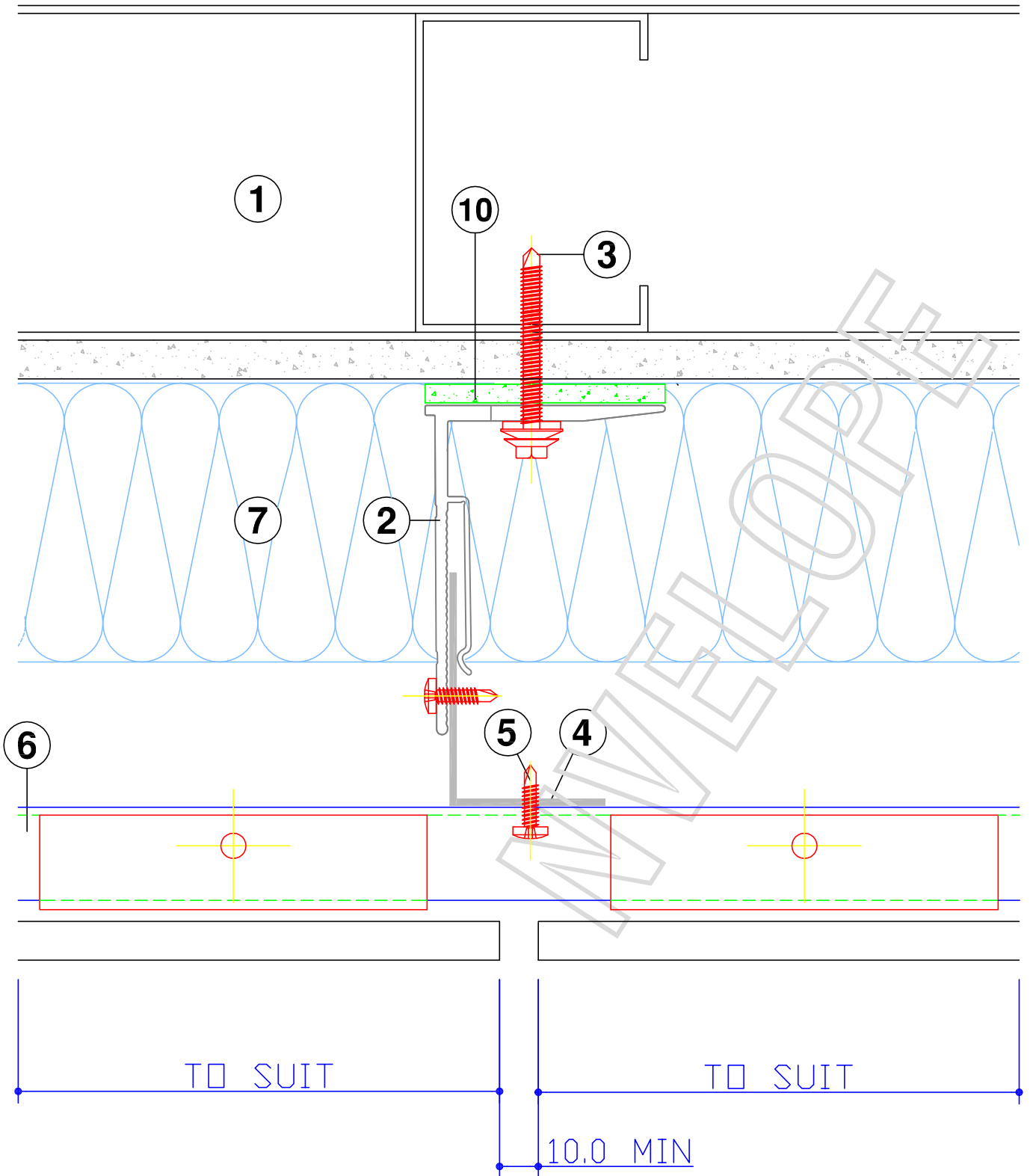

HORIZONTAL SECTION - NVELOPE 90

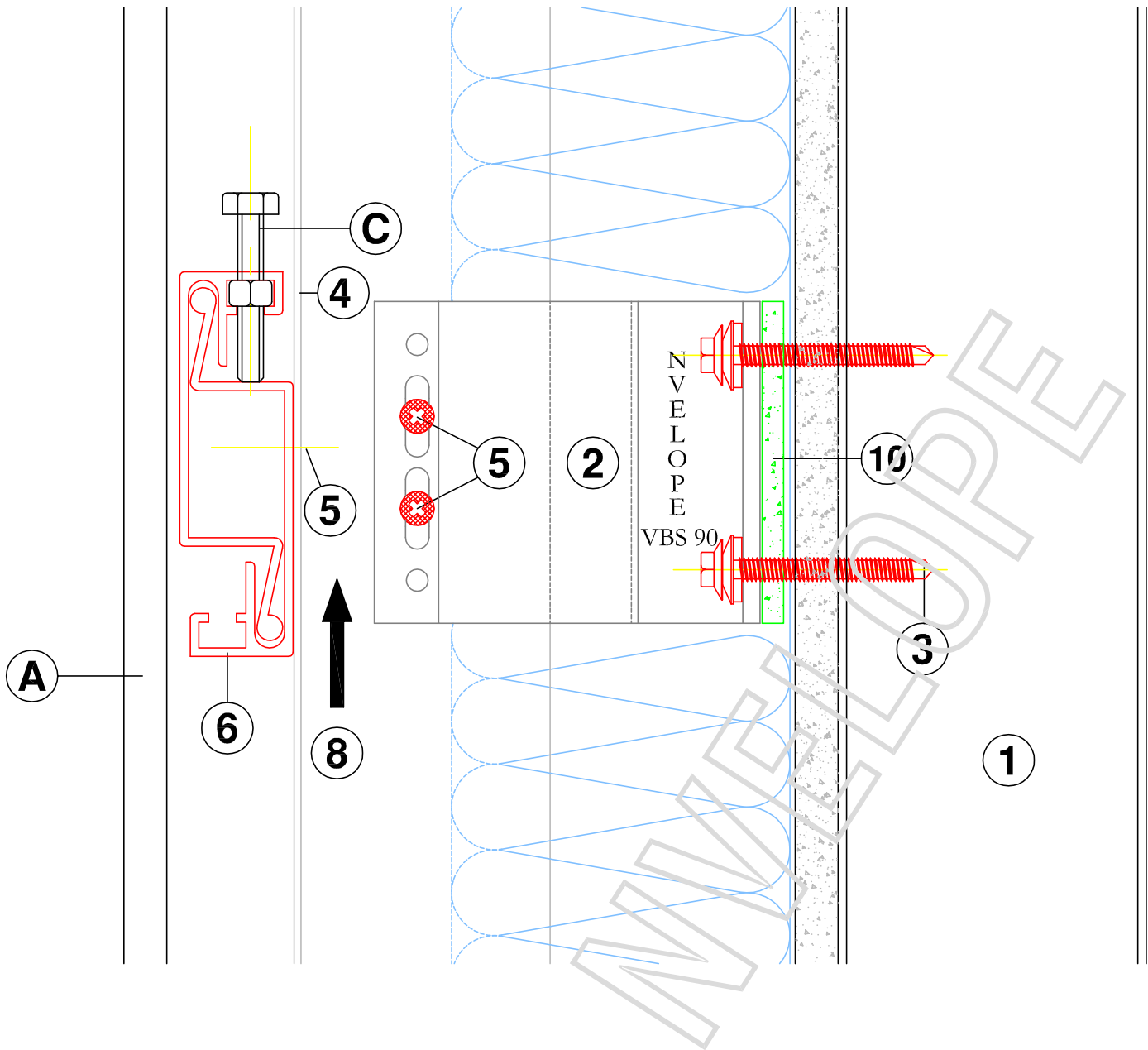

VERTICAL SECTION - NVELOPE 90 SINGLE

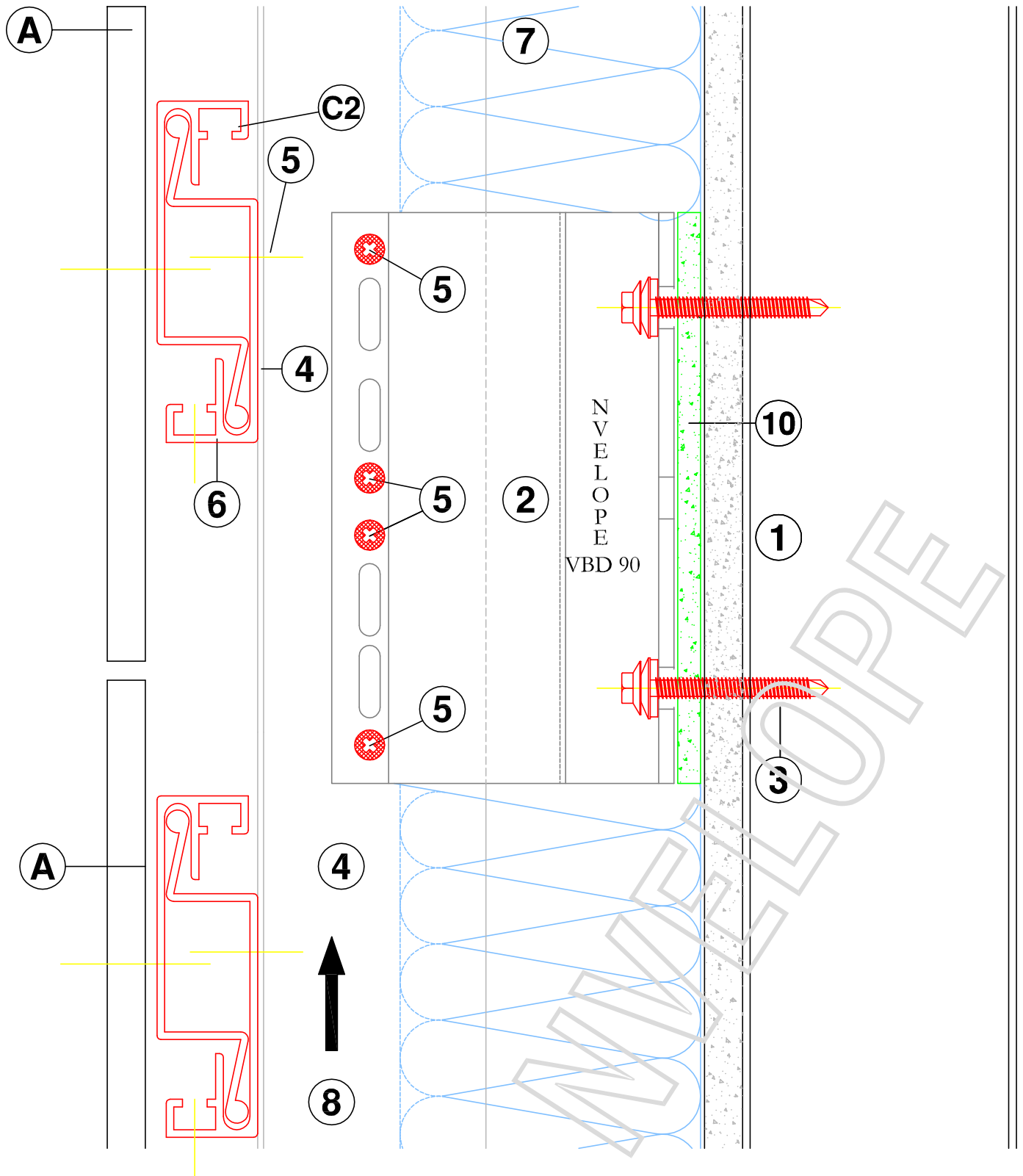

VERTICAL SECTION - NVELOPE DOUBLE

NVELOPE

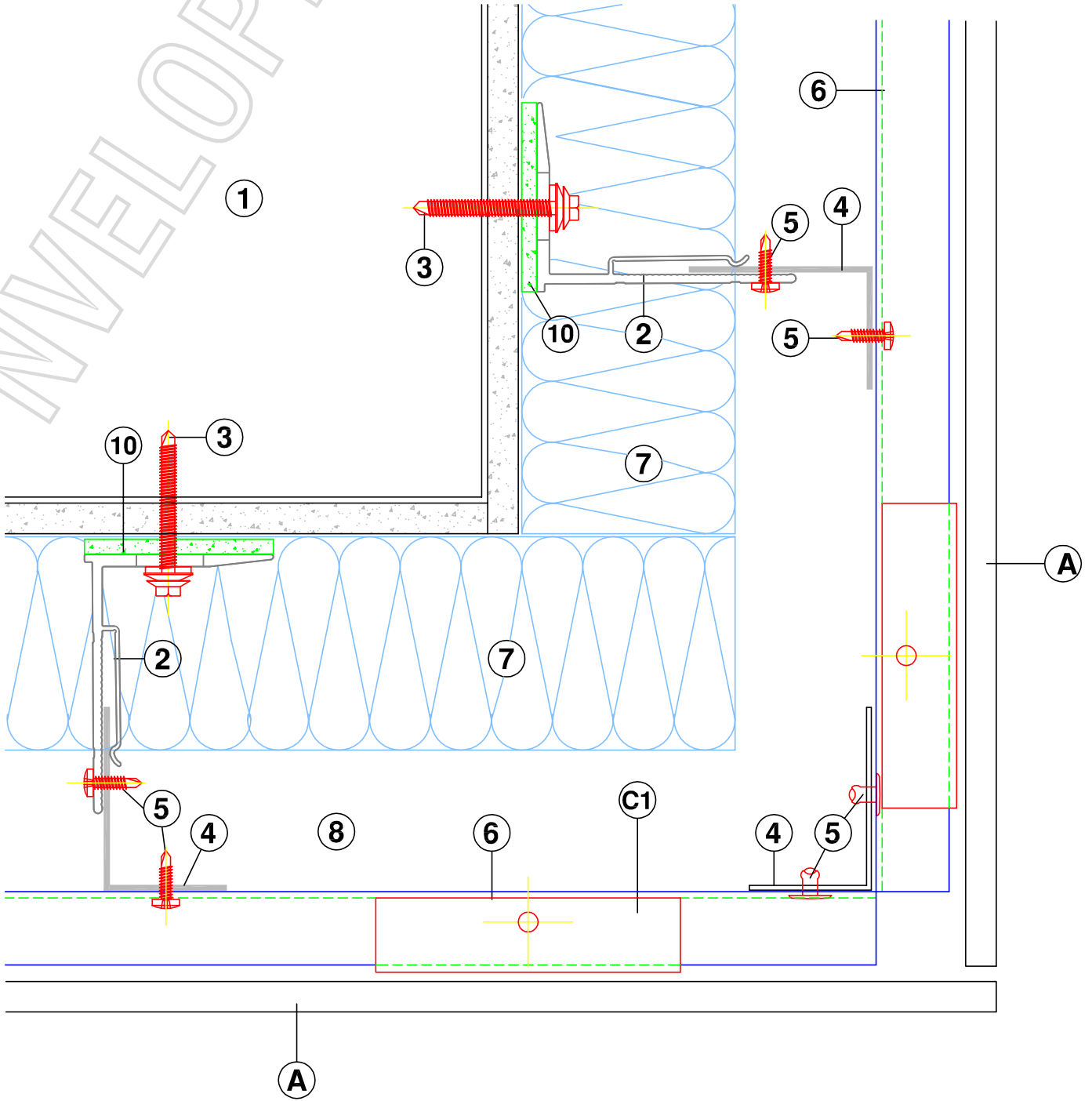

HORIZONTAL SECTION - EXTERNAL CORNER



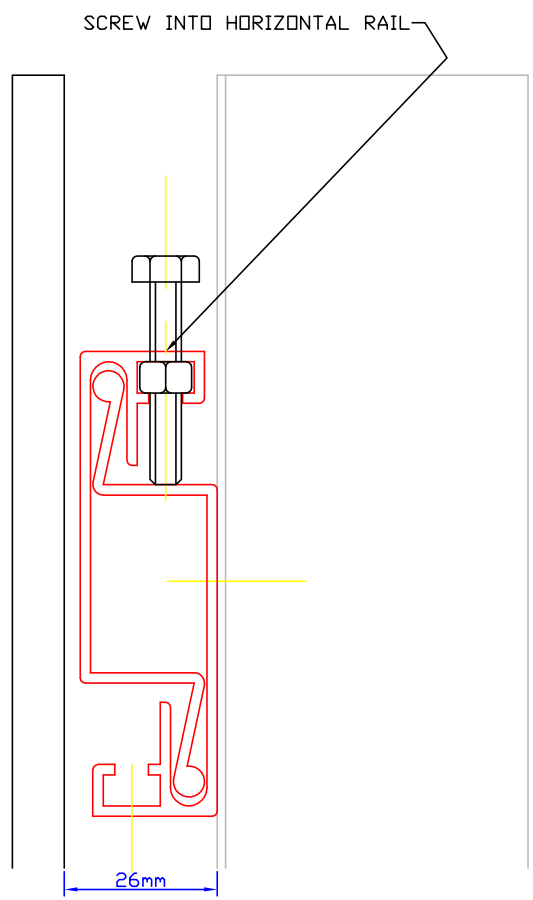
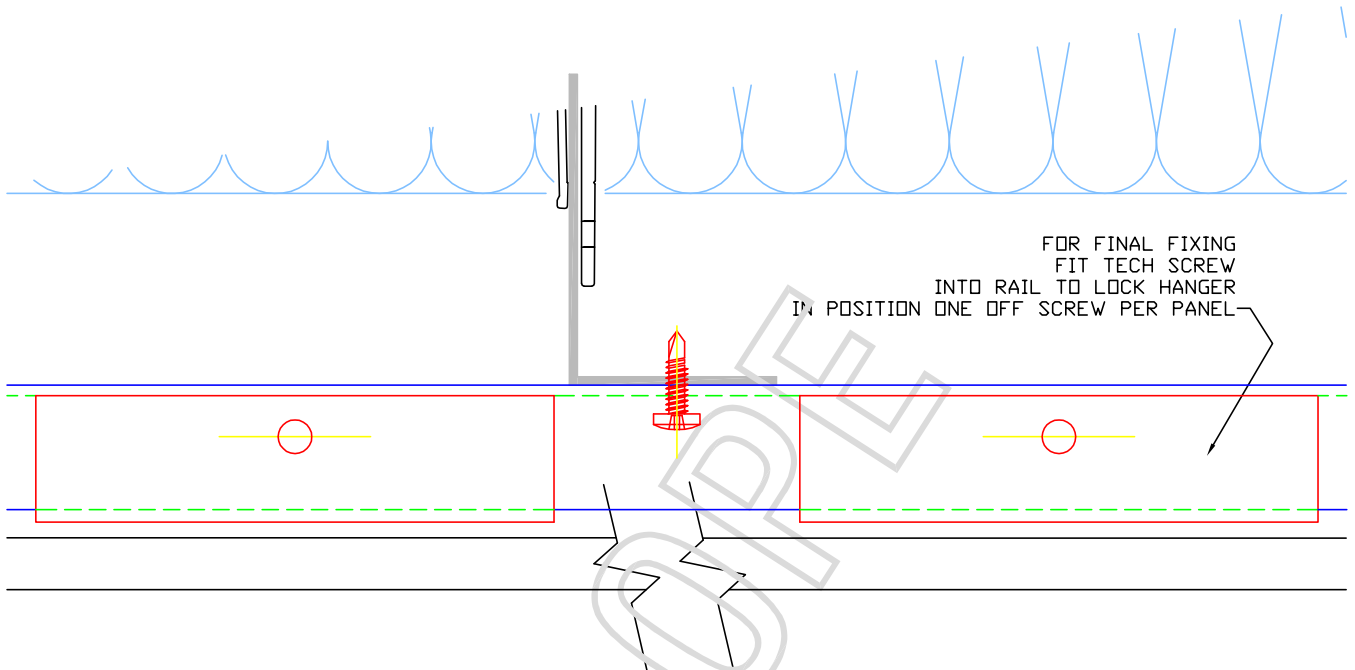

FINAL FIXING SCREW



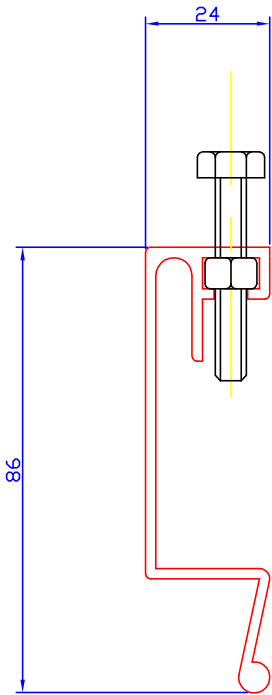

NV8 CLIP

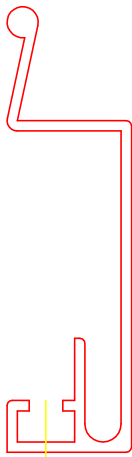
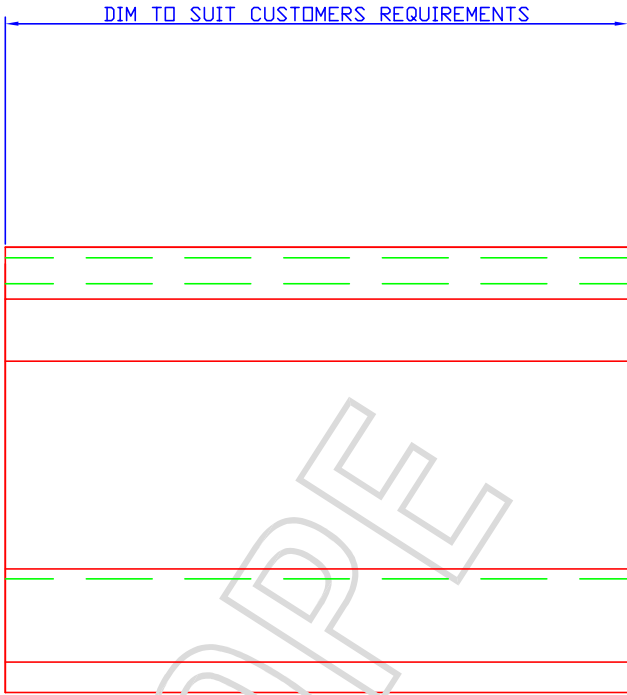

NV8 RAILS

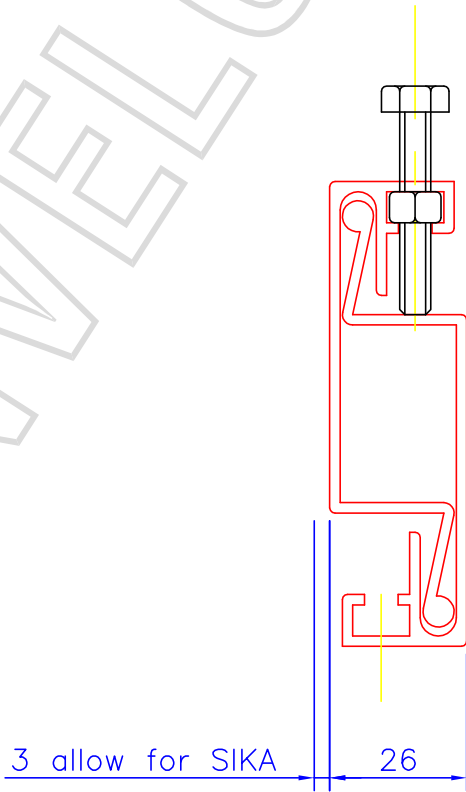

ASSEMBLY DIM

